

DN500 Manlid Assembly with Emergency Drain Device-8 points. The emergency drain device is installed on the manlid cover. When the pressure in the tank is 21kPa~35kPa, the emergency drain device is started to balance the internal and external pressure of the tank and ensure that the tank body is in a safe pressure state.

Cover body suitable for Guard DN500 low profile neckring and deep neckring.

Stainless steel swing bolt with stainless steel nut. With customs lead seals, seal sold separately.

Option-The maximum opening angle is standard 135° and optional 120°.

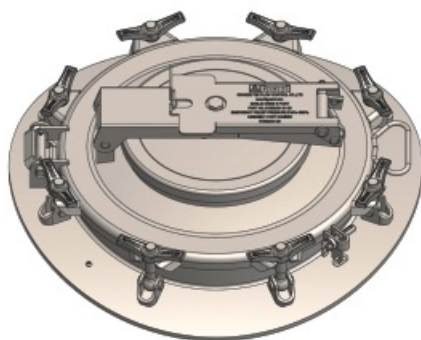

Part No.: R1583A01-00
 Nominal Diameter: 500mm
 Nominal Pressure: 4Bar(58PSI)
 Points: 8
 Design Temperature: - 40°C ~ + 200°C
 Weight: 24.5kg
 Weight: 15kg

Temperature range depends on the seal

Fitting Details

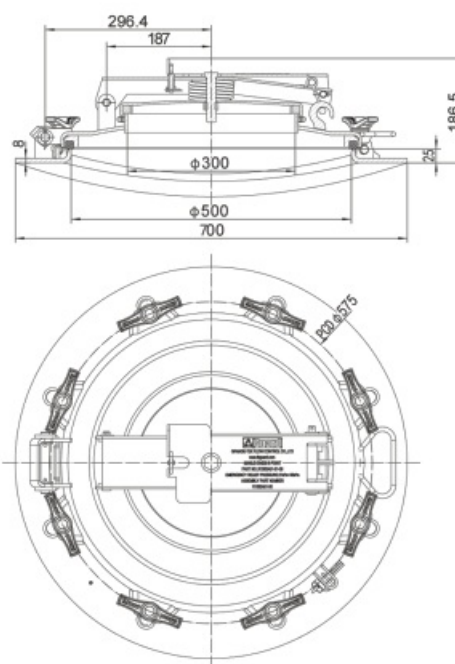

Part Drawing

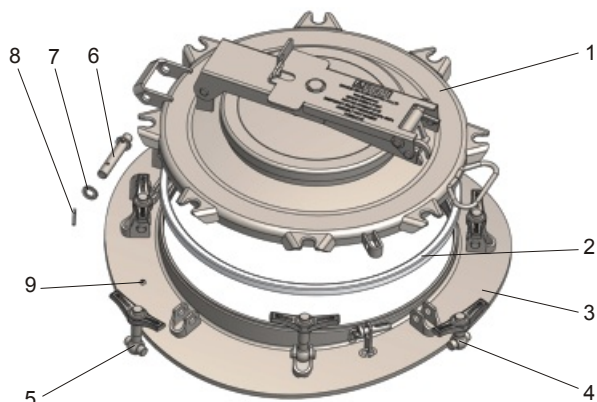

Item	Part No.	Description
1	R1583A01-01-00	DN500 Cover
2	见密封件数据表	Seal
3	R4583A09-01-00	DN500 Neckring
4	R4583A01-10-00	Bolt Assembly
5	R4583A09-02-00	Bolt Assembly
6	R4583A01-03	Hinge Pin
7	R4583A01-12	Gasket
8	859960004*25	Split Pin
9	85988500M6*8	Screw